

Orona 3G

1020

## Machine-room above electrical gearless solutions

With the latest direct drive (Gearless) technology.  
The base solution with machine-room and latest technology.

### General specifications

Load	320 - 450 - 630 kg
Capacity	4 - 6 - 8 persons
Speed	1 m/s
Maximum travel	45 m
Maximum floors served	16 floors
Entrances	1 front / 2 open through / 2 front & side
Drive system	Direct gearless
Controller	ARCA II controller, low energy microprocessor
Door types	Automatic side-opening / Automatic central-opening
Clear door opening	700 / 800 / 900
Door height	2,000 / 2,100
Car dimensions	Standard car dimensions
Internal car height	2,100 / 2,200
Aesthetic solutions	DR1 / DR2 / DR3 / DR4 / DR5 / DR6 / DR7 / DR8 DS1 / DS2 / DS3 / DS4 / DS5 / Orona 3G Domo Plus

Standard Optional

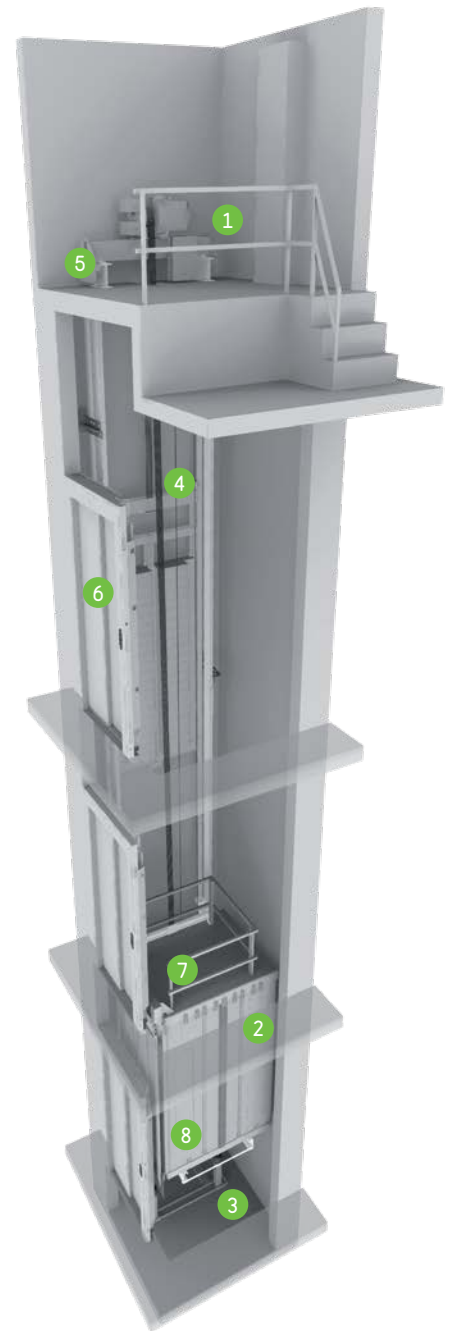

#### 1 MACHINE-ROOM

A traditional solution simplifying lift maintenance.



#### 2 OPTIMISED PASSENGER UNIT

Saves space, reduces weight, improves safety, and improves the installation process.



#### 3 ACCESSIBLE SPACE BELOW THE PIT

Adapts the lift to suit buildings which have an accessible space below the pit (optional).



#### 4 TRACTION ROPES

Orona small diameter ropes replace traditional steel ropes. As a result of their lighter weight, longer lifespan and greater flexibility, it is possible to use a more compact, efficient and eco-friendly gearless machine.



#### 5 DRIVE

Compact, quiet, gearless, energy efficient, speed regulated (VVVF) permanent magnet electric motor.



#### 6 DOORS

Compact permanent magnet motor for fast, accurate and quiet door operation giving the most advanced performance. Advanced door opening and full height infra red door protection edges.



#### 7 AUTOMATIC RESCUE SYSTEM

With floor level indication to ensure fast, efficient and safe evacuation of passengers in the event of an emergency. As an option, the system can incorporate a fully-automatic rescue device to evacuate passengers in the event of a power failure.



#### 8 TWO-WAY COMMUNICATIONS

Between the lift and the emergency 24-hour Service Call Centre according to EN 81-28.



## Standard dimensions

Load / Capacity		Car			Lift shaft *							
Persons	Q Load	AC Width	FC Depth	PL Clear opening	Entrances		Side-opening doors		Central-opening doors		HF Pit	HUP Last Floor
					Accessibility	No. of entrances	AH <sup>1</sup> Width	FH <sup>2</sup> Depth	AH Width	FH <sup>3</sup> Depth		
4	320 kg	825	1100	700		1	1325	1350	1600	1300	1000 (850) <sup>4</sup>	3400
						2 x 180 <sup>0</sup>		1500		1400		
						2 x 90 <sup>0</sup>	1450	1350				
6	450 kg	1000	1250	800	♿	1	1500	1500	1800	1450	1000 (850) <sup>4</sup>	3400 (3000) <sup>5</sup>
						2 x 180 <sup>0</sup>		1650		1550		3400
						* <sup>6</sup>	2 x 90 <sup>0</sup>	1625	1500			
8	630 kg	1100	1400	900	♿	1	1600	1650	2000	1600	1000 (850) <sup>4</sup>	3400 (3000) <sup>5</sup>
						2 x 180 <sup>0</sup>		1800		1700		
						2 x 90 <sup>0</sup>	1725	1650				
	1200	1250	900	* <sup>6</sup>	1	1700	1500	2000	1450	1000 (850) <sup>4</sup>	3400	
					2 x 180 <sup>0</sup>		1650		1550			
					2 x 90 <sup>0</sup>	1825	1575					

- 1 Accessible space below the pit (counterweight with safety gear) add 50 mm to AH
- 2 Shaft depth with door tracks projecting 60 mm on the landing
- 3 Shaft depth with door tracks projecting 40 mm on the landing
- 4 HF reduced pit optional 850 mm

- 5 Minimum HUP for internal car height (HC) of 2100 mm (HUP = HC + 1,300)  
HUP reduced headroom optional only for 6 and 8 persons (HUP = HC + 900)
  - 6 Adapted for disabled people, according to European standard EN 81-70
- \* Minimum plumb measurements

## Layout

1 ENTRANCE

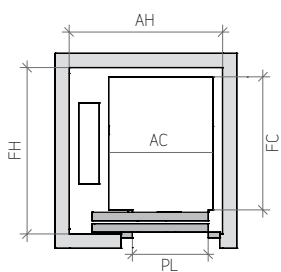

2 ENTRANCES (OPEN THROUGH)

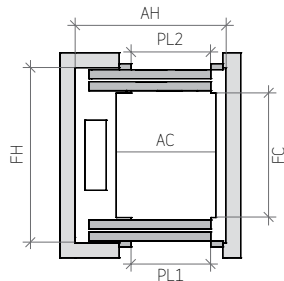

2 ENTRANCES (FRONT & SIDE)

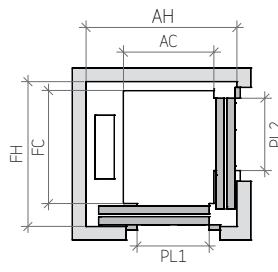

VERTICAL SECTION

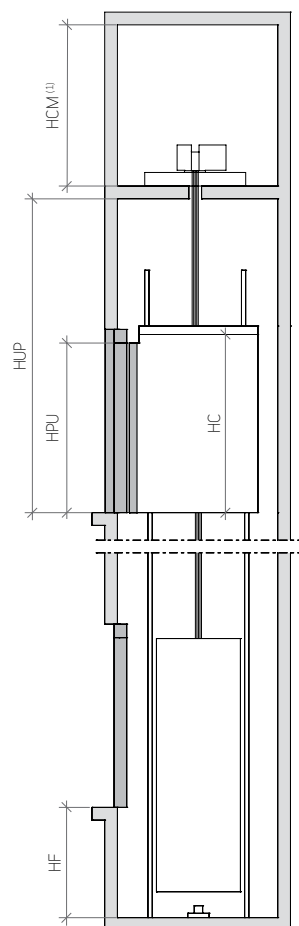

(1) HCM - minimum 2,000 mm

WIDE-FRAMED DOOR DETAIL

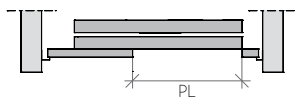

Orona 3G

# 1025

## Machine-room above electrical gearless solutions

With the latest direct drive (gearless) technology. The customised solution with machine-room, maximum flexibility and greatest performance.

### General specifications

Load	320 to 1,000 kg
Capacity	4 to 13 persons
Speed	1 - 1.6 m/s
Maximum travel	50 - 60 m
Maximum floors served	16 - 21 floors
Entrances	1 front / 2 open through
Drive system	Direct gearless
Controller	ARCA II controller, low energy microprocessor
Door types	Automatic side-opening / Automatic central-opening
Clear door opening	From 600 to 1,500 mm (in 100 mm increments)
Door height	2,000 / 2,100 / 2,200 / 2,300
Car dimensions	Parametric car dimensions
Internal car height	2,100 / 2,200 / 2,300 / 2,400
Aesthetic solutions	DR1 / DR2 / DR3 / DR4 / DR5 / DR6 / DR7 / DR8 DS1 / DS2 / DS3 / DS4 / DS5 / Orona 3G Domo Plus

Standard Optional

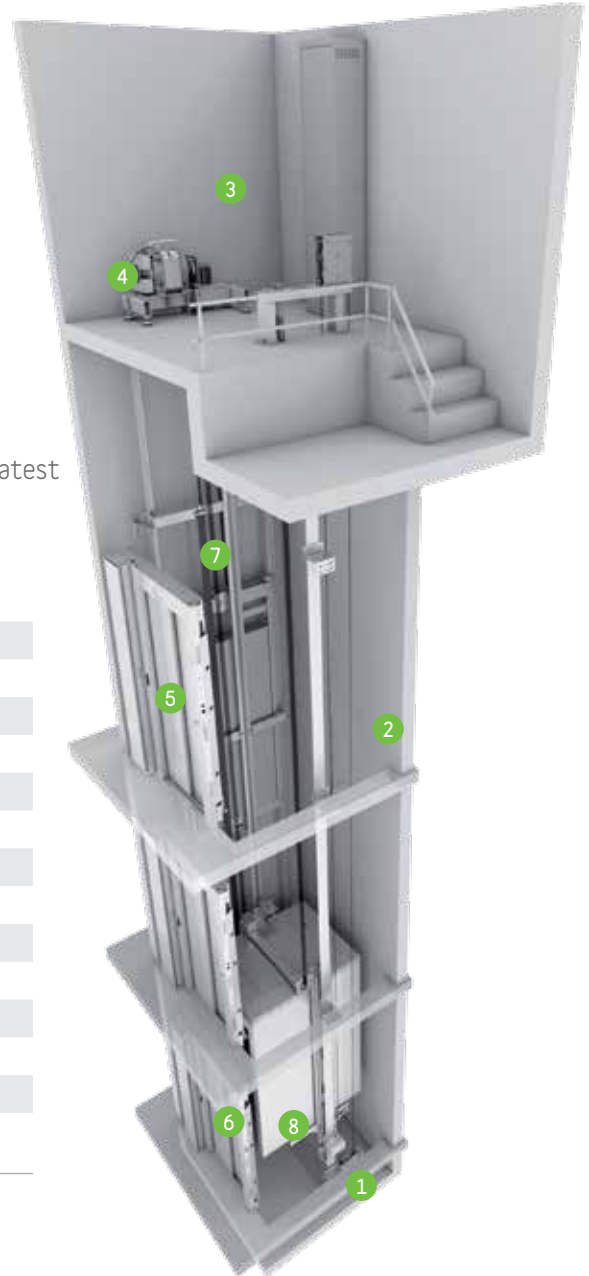

#### 1 ACCESSIBLE SPACE BELLOW THE PIT

Adapts the lift to suit buildings which have an accessible space below the pit (optional).



#### 2 PARAMETRIC/FLEXIBLE

Flexible car and door configurations ensure available shaft dimensions can be optimised (optional).



#### 3 MACHINE-ROOM

A traditional solution simplifying lift maintenance.



#### 4 DRIVE

Compact, quiet, gearless, energy efficient, speed regulated (VVVF) permanent magnet electric motor.



#### 5 DOORS

Compact permanent magnet motor for fast, accurate and quiet door operation giving the most advanced performance. Advanced door opening and full height infra red door protection edges for medium flow situations. Optional Solid Door for high flow situations.



#### 6 AUTOMATIC RESCUE SYSTEM

With floor level indication to ensure fast, efficient and safe evacuation of passengers in the event of an emergency. As an option, the system can incorporate a fully-automatic rescue device to evacuate passengers in the event of a power failure.



#### 7 TRACTION ROPES

Orona small diameter ropes replace traditional steel ropes. As a result of their lighter weight, longer lifespan and greater flexibility, it is possible to use a more compact, efficient and eco-friendly gearless machine.



#### 8 TWO-WAY COMMUNICATIONS

Between the lift and the emergency 24-hour Service Call Centre according to EN 81-28.



## Standard dimensions

Load / Capacity			Car			Lift shaft *							
Speed	Persons	Q Load	AC Width	FC Depth	PL Clear opening	Entrances		Side-opening doors		Central-opening doors		HF Pit	HUP Last Floor
						Accessibility	No. of entrances	AH <sup>1</sup> Width	FH <sup>2</sup> Depth	AH Width	FH <sup>3</sup> Depth		
1 m/s	4	320 kg	825	1,100	700		1	1,300	1,350				
							2 x 180 <sup>0</sup>		1,500				
	6	450 kg	1,000	1,250	800	♿	1	1,450	1,500	1,725	1,450		
							2 x 180 <sup>0</sup>		1,650		1,550		
	8	630 kg	1,100	1,400	900		1	1,600	1,675	1,925	1,625		
							2 x 180 <sup>0</sup>		1,850		1,750		
	10	800 kg	1,350	1,400	900	♿	1	1,825	1,675	1,925	1,625		
							2 x 180 <sup>0</sup>		1,850		1,750		
13	1,000 kg	1,600	1,400	1,000		1	2,075	1,675	2,150	1,625			
						2 x 180 <sup>0</sup>		1,850		1,750			
		1,100	2,100	1,000		1	1,775	2,375	2,125	2,300			
						2 x 180 <sup>0</sup>		2,550		2,400			
1.6 m/s	4	320 kg	825	1,100	700		1	1,325	1,350				
							2 x 180 <sup>0</sup>		1,500				
	6	450 kg	1,000	1,250	800	♿	1	1,475	1,500	1,725	1,450		
							2 x 180 <sup>0</sup>		1,650		1,550		
	8	630 kg	1,100	1,400	900		1	1,625	1,675	1,925	1,625		
							2 x 180 <sup>0</sup>		1,850		1,750		
	10	800 kg	1,350	1,400	900	♿	1	1,850	1,675	1,925	1,625		
							2 x 180 <sup>0</sup>		1,850		1,750		
13	1,000 kg	1,600	1,400	1,000		1	2,100	1,675	2,175	1,625			
						2 x 180 <sup>0</sup>		1,850		1,750			
		1,100	2,100	1,000		1	1,775	2,375	2,125	2,300			
						2 x 180 <sup>0</sup>		2,550		2,400			

- 1 Accessible space below the pit (counterweight with safety gear) add 115 mm to AH
- 2 Shaft depth with door tracks projecting 60 mm on the landing
- 3 Shaft depth with door tracks projecting 40 mm on the landing

- 4 HF reduced pit optional 830 mm
  - 5 Minimum HUP for internal car height (HC) of 2,100 mm (HUP=HC+1,300)  
HF reduced pit optional (HUP=HC+900) Consult availability of car dimensions
- \* Minimum plumb measurements

## Layout

### 1 ENTRANCE

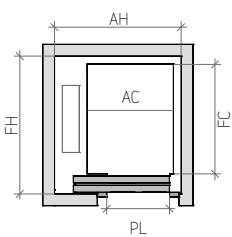

### 2 ENTRANCES (OPEN THROUGH)

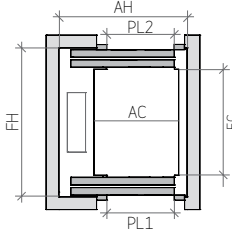

### WIDE-FRAMED DOOR DETAIL

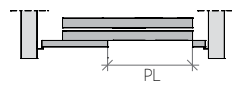

### VERTICAL SECTION

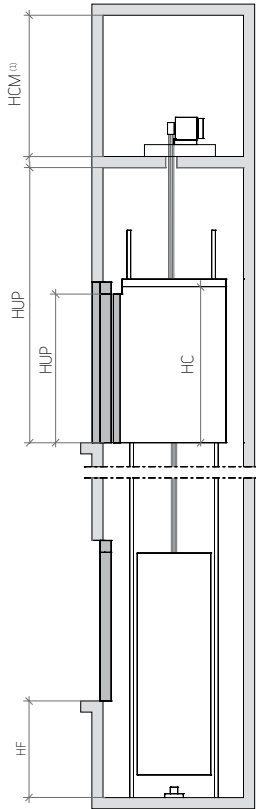

## Customised car dimensions

		Car width										Car depth									
		13	12	11	10	9	8	7	6	5	4	13	12	11	10	9	8	7	6	5	4
2,100	2,000	1,900	1,800	1,700	1,600	1,500	1,400	1,300	1,200	1,100	1,000	1,600	1,500	1,400	1,300	1,200	1,100	1,000	900	800	

Clear door opening

Note:  
Car width and depth variable in increments of 5 mm.  
For simplification, table samples show increments of 100 mm.

(1) HCM - minimum 2,000 mm

Orona 3G

1030

## Hydraulic drive solutions

For light-traffic applications.  
The versatile and adaptable hydraulic solution.

### General specifications

Load	320 to 1,000 kg
Capacity	4 to 13 persons
Speed	0.6 m/s
Maximum travel	21 m
Maximum floors served	7 floors or 14 floors (only with two entrances)
Entrances	1 front / 2 open through / 2 front & side
Drive system	Hydraulic
Controller	ARCA II controller, low energy microprocessor
Door types	Semiautomatic + Articulated (BUS) / Automatic side-opening / Automatic central-opening
Clear door opening	From 600 to 1,600 mm (in 100 mm increments)
Door height	2,000 / 2,100
Car dimensions	Parametric car dimensions
Internal car height	2,100 / 2,200
Aesthetic solutions	DR1 / DR2 / DR3 / DR4 / DR5 / DR6 / DR7 / DR8 DS1 / DS2 / DS3 / DS4 / DS5 / Orona 3G Domo Plus

Standard Optional

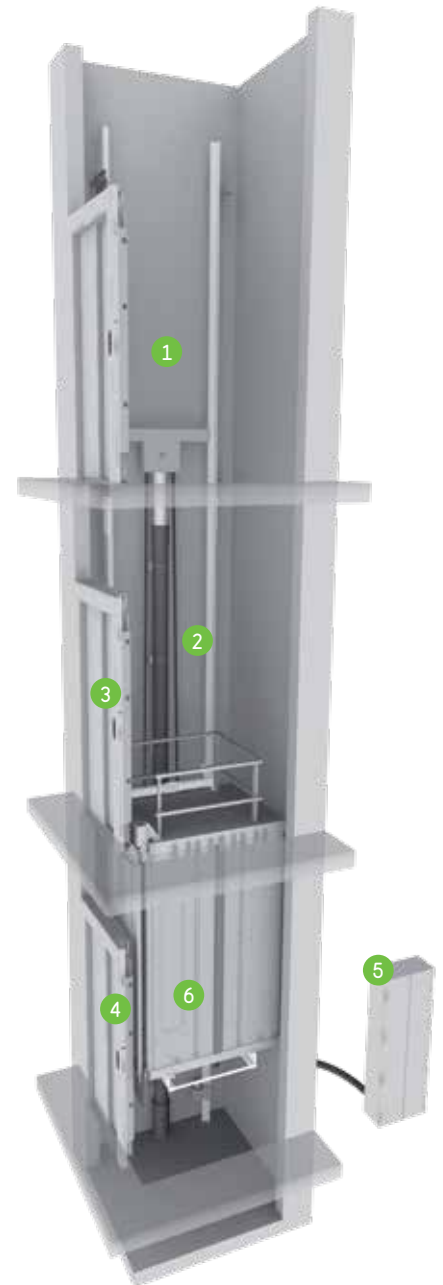

#### 1 HYDRAULIC LIFTS

The hydraulic systems, renowned for their long life cycle, are very versatile and offer convenient solutions to high load requirements or reduced shaft spaces.



#### 2 PARAMETRIC/FLEXIBLE

Flexible car and door configurations ensure available shaft dimensions can be optimised (optional).



#### 3 DOORS

Compact permanent magnet motor for fast, accurate and quiet door operation giving the most advanced performance. Advanced door opening and full height infra red door protection edges.



#### 4 CAR ACCESSIBILITY

Optional EN 81-70 accessible car.  
Optional car light control, including LED lighting options.



#### 5 REDUCED MACHINE ROOM

As an alternative to a machine-room, the controller/machinery can be fitted into a metal cabinet and located in a convenient location within the building.



#### 6 TWO-WAY COMMUNICATIONS

Between the lift and the emergency 24-hour Service Call Centre according to EN 81-28.



ECO-EFFICIENCY



ADAPTABILITY



DESIGN AND ACCESSIBILITY



CONTROL AND SAFETY

# Standard dimensions

Load / Capacity		Lift shaft *										HF Pit	HUP <sup>2</sup> Last Floor
		Side piston (TT Doors)							Rear piston (HH Doors)				
		Standard car			Lift shaft				Lift shaft				
Persons	Q Load	AC Width	FC Depth	PL Clear opening	Entrances		AH Width	FH <sup>1</sup> Depth	AH Width	FH <sup>1</sup> Depth			
					Accessibility	No. of entrances							
4	320 kg	825	1,100	700		1	1,250	1,350	1,175	1,650			
						2 x 180 <sup>0</sup>	1,250	1,500					
						2 x 90 <sup>0</sup>	1,400	1,350	1,175	1,650			
6	450 kg	1,000	1,250	800	♿	1	1,425	1,500	1,325	1,800	1,050		
							2 x 180 <sup>0</sup>	1,425	1,650				
							2 x 90 <sup>0</sup>	1,575	1,500	1,325			1,800
8	630 kg	1,100	1,400	900	♿	1	1,575	1,650					
							2 x 180 <sup>0</sup>	1,575	1,800				
							2 x 90 <sup>0</sup>	1,675	1,650				
10	800 kg	1,350	1,400	900	♿	1	1,800	1,650	1,700	1,975			
							2 x 180 <sup>0</sup>	1,800	1,800				
							2 x 90 <sup>0</sup>	1,925	1,650	1,700			1,975
13	1,000 kg	1,100	2,100	900	♿	1	1,550	2,350			1,100		
							2 x 180 <sup>0</sup>	1,550	2,500				
							2 x 90 <sup>0</sup>	1,675	2,350				
		1,600	1,400	1,000	♿	1			1,700	1,975			
							2 x 180 <sup>0</sup>						
							2 x 90 <sup>0</sup>			1,850	1,975		

- Shaft depth with door tracks projecting 60 mm on the landing
- Minimum HUP for internal car height (HC) of 2,100 mm (HUP = HC+1,225)

TT - Two panel telescopic door  
 HH - Four panel central door  
 \* Minimum plumb measurements

## Layout

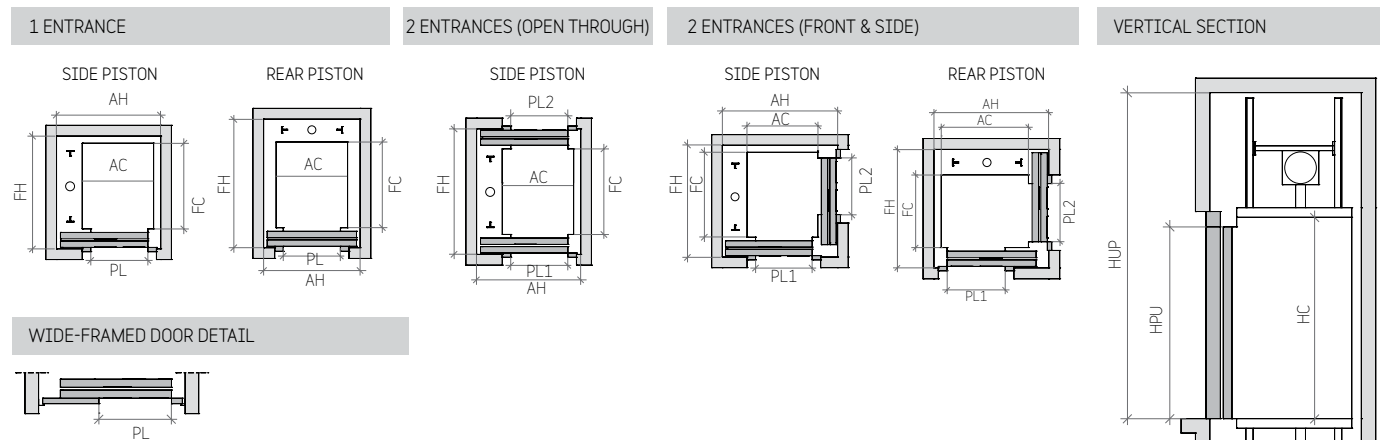

## Customised car dimensions

		Car width																						
		16	15	14	13	12	11	10	9	8	7	6	5	4	Car depth	Clear door opening								
16	16	16	15	14	13	12	11	10	9	8	7	6	5	4	2,100	600	700	800	900	1,000	1,100	1,200	1,300	1,400
15	14	13	13	12	10	10	9	8	8	7	6	5	5	4	2,000									
13	13	12	11	10	10	9	8	8	7	6	5	5	4	1,900										
12	11	10	10	9	8	8	7	7	6	5	5	4	4	1,800										
10	10	9	8	8	8	7	6	6	5	5	4	4	4	1,700										
9	8	8	8	7	7	6	5	5	5	4	4	4	4	1,600										
															1,500									
															1,400									
															1,300									
															1,200									
															1,100									
															1,000									
															900									
															800									

		Car width																							
		13	12	10	9	2,100	Car depth	Clear door opening																	
		13	12	10	9	2,000																			
			13	12	10	9	1,900																		
				13	12	10	9	1,800																	
					13	12	10	9	8	7	1,700														
						13	12	10	9	8	7	1,600													
							13	12	10	8	8	7	1,500												
								13	12	10	9	8	1,400												
									13	12	10	9	1,300												
										13	12	10	1,200												
											13	12	1,100												
												13	1,000												
													1,100												
														1,200											
															1,300										
																1,400									
																	1,500								
																		1,600							

Note:  
 Car width and depth variable in increments of 5 mm.  
 For simplification, table samples show increments of 100 mm.

Note:  
 Car width and depth variable in increments of 5 mm.  
 For simplification, table samples show increments of 100 mm.

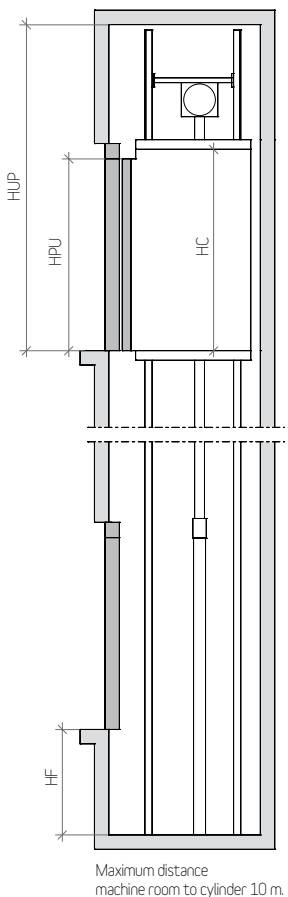

# Reference Packs

---



DR1



DR2



DR3



DR4

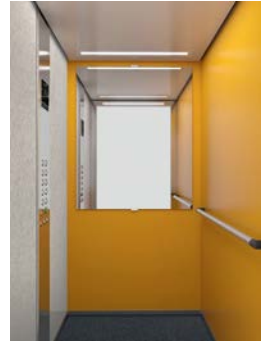

DR5



DR6



DR7



DR8

# Selection Packs

---



DS1



DS2



DS3



DS4



DS5

# Orona 3G Domo Packs

## REFERENCE PACKS

## SELECTION PACKS

DR1 DR2 DR3 DR4 DR5 DR6 DR7 DR8 DS1 DS2 DS3 DS4 DS5

### CEILINGS AND LIGHTING

MODEL	LED	UP17			•			•						
		UP19	•			•	•		•	•				
		UP23		•										
	LED Spots	UP31									•			
UP37		•	•	•	•	•	•	•	•	•	•	•	•	
	LED panel (200 x 200 mm)	UP41								•				
CEILING MATERIAL	ST01 St St Base		•	•	•	•	•	•	•	•	•	•	•	
	ST02 St St Plus		•	•	•	•	•	•	•	•	•	•	•	
OTHERS	Automatic lighting switch-off		•	•	•	•	•	•	•	•	•	•	•	
	Emergency hatch		•	•	•	•	•	•	•	•	•	•	•	
	Fan		•	•	•	•	•	•	•	•	•	•	•	

### CAR WALLS

PANELS	Neocompact Colour	NC02 Red Autumn			•P								
		NC03 White Snow	•	•	•	•		•	•				•
		NC05 Blue Berry		•P									
		NC08 Yellow Sunset					•						
		NC09 Green Orona				•P						•	
	Neocompact Wood	NC11 Cherry Tree						•F			•		
		NC16 Linen Pure									•		
	Neocompact Texture	NC17 Grey Storm									•		
		NC18 Night Garden							•F				•F
		NC19 White Garden					•P					•P	
Panel Stainless	ST01 St St Base											•	
	ST02 St St Plus											•	
Others	Without cladding (for local fit out)		•	•	•	•	•	•	•	•	•	•	
	Tip-up seat		•	•	•	•	•	•	•	•	•	•	
	2 Entrances or 'Through car' for 180, 'Front/Adjacent' for 90 & 270		•	•	•	•	•	•	•	•	•	•	

### CAR OPERATING PANELS AND INDICATORS

CAR INDICATOR	7 Segment	•	•	•	•	•	•	•	•				
	Dot-matrix									•	•		•
	TFT											•	
	Car direction arrows	•	•	•	•	•	•	•	•	•	•	•	•
	Overload indicator (buzzer & light)	•	•	•	•	•	•	•	•	•	•	•	•
	Direction arrows on entrance return	•	•	•	•	•	•	•	•	•	•	•	•
	Car gong	•	•	•	•	•	•	•	•	•	•	•	•
	Voice synthesizer	•	•	•	•	•	•	•	•	•	•	•	•
CAR OPERATING PANEL MATERIAL	ST01 St St Base	•	•	•	•	•	•	•	•	•	•	•	
	ST02 St St Plus	•	•	•	•	•	•	•	•	•	•	•	
CAR PUSH BUTTONS	Door close push button	•	•	•	•	•	•	•	•	•	•	•	
	Braille push button	•	•	•	•	•	•	•	•	•	•	•	
	Key switch push button (Standard or eurocylinder)	•	•	•	•	•	•	•	•	•	•	•	
	External call cancelling	•	•	•	•	•	•	•	•	•	•	•	
	Coded call	•	•	•	•	•	•	•	•	•	•	•	
LANDING INDICATOR	7 Segment	•	•	•	•	•	•	•	•	•	•	•	
	Dot-matrix									•	•	•	
	Next departure indicator	•	•	•	•	•	•	•	•	•	•	•	
	Landing gong	•	•	•	•	•	•	•	•	•	•	•	
LANDING PUSH BUTTONS	Key switch push button (Standard or eurocylinder)	•	•	•	•	•	•	•	•	•	•	•	
	Surface mounted push buttons	•	•	•	•	•	•	•	•	•	•	•	

### MIRRORS

MIRRORS	MH (Mirror 1/2)	•F	•F	•F	•F	•F	•F	•F	•F				
	MT (Mirror 3/4 narrow)									•F	•F	•F	•F
FINISH	Rear-view mirror (EN 81-70)	•	•	•	•	•	•	•	•	•	•	•	•
	O1 Clear	•	•	•	•	•	•	•	•	•	•	•	•

### HANDRAILS

HANDRAILS	HR01 (Aluminium tube)	•L	•L	•L	•L	•L	•L	•L	•L				
	HR02 (Aluminium tube)									•F/L	•F/L		•F/L
	HR04 (Stainless steel tube)											•F/L	•F/L

### FINISHES

SKIRTINGS	SK01 Anodized Aluminium (St St finish)	•	•	•	•	•	•	•	•	•	•	•	•
DOOR MATERIALS (car and landing)	ST01 St St Base	•	•	•	•	•	•	•	•	•	•	•	•
	ST02 St St Plus	•	•	•	•	•	•	•	•	•	•	•	•
	Primed sheet (landing door)	•	•	•	•	•	•	•	•	•	•	•	•
DOOR PANEL TYPE	Standard panel (not big vision)	•	•	•	•	•	•	•	•	•	•	•	

### FLOORS

SC-PVC HIGH	SC03 Grey Ice		•		•						•		
	SC04 Grey Storm					•		•			•		•
	SC05 Grey Silver	•		•					•				•
	SC06 Beige Sand						•						
OTHERS	Prepared for granite	•	•	•	•	•	•	•	•	•	•	•	•
	Prepared for PVC	•	•	•	•	•	•	•	•	•	•	•	•



# Reference Packs

---



PR1



PR2



PR3



PR4



PR5

# Selection Packs

---



PS1



PS2



PS3



PS4



PS5



PS6



PS7



PS8



PS9

# Orona 3G Public Packs

## REFERENCE PACKS

## SELECTION PACKS

PR1 PR2 PR3 PR4 PR5 PS1 PS2 PS3 PS4 PS5 PS6 PS7 PS8 PS9

### CEILINGINGS AND LIGHTING

MODEL	LED Spots	UP31 UP37	•	•														
	LED Panel (200 x 200 mm)	UP41 UP43			•			•					•		•			
	LED Panel (600 x 600 mm)	UP47 UP53									•			•				•
CEILING MATERIAL	ST01 St St Base		•	•	•	•	•	•	•	•	•	•	•	•	•	•	•	•
	ST02 St St Plus		•	•	•	•	•	•	•	•	•	•	•	•	•	•	•	•
OTHERS	Automatic lighting switch-off		•	•	•	•	•	•	•	•	•	•	•	•	•	•	•	•
	Emergency hatch		•	•	•	•	•	•	•	•	•	•	•	•	•	•	•	•
	Fan		•	•	•	•	•	•	•	•	•	•	•	•	•	•	•	•

### CAR WALLS

PANELS	Neocompact Colour	NC03 White Snow		•				•P	•		•P		•P						
		NC05 Blue Berry				•P										•L			
		NC09 Green Orona			•										•				
	Neocompact Wood	NC11 Cherry Tree		•															
		NC12 Wood Sinatra						•	•F										
	Neocompact Texture	NC16 Linen Pure								•									
		NC18 Night Garden				•P						•	•P						
		NC19 White Garden		•F															
	Panel Stainless	ST01 St St Base				•	•						•		•	•	•	•	•
		ST02 St St Plus				•	•						•		•	•	•	•	•
Others	Without cladding (for local fit out)		•	•	•	•	•	•	•	•	•	•	•	•	•	•	•	•	
	Tip-up seat		•	•	•	•	•	•	•	•	•	•	•	•	•	•	•	•	
	2 Entrances or 'Through car' for 180, 'Front/Adjacent' for 90&270		•	•	•	•	•	•	•	•	•	•	•	•	•	•	•	•	

### CAR OPERATING PANELS AND INDICATORS

CAR INDICATOR	Dot-matrix		•	•	•	•	•											
	TFT							•	•	•	•	•	•	•	•	•	•	•
	Car direction arrows		•	•	•	•	•	•	•	•	•	•	•	•	•	•	•	•
	Overload indicator (buzzer & light)		•	•	•	•	•	•	•	•	•	•	•	•	•	•	•	•
	Direction arrows on entrance return		•	•	•	•	•	•	•	•	•	•	•	•	•	•	•	•
	Car gong		•	•	•	•	•	•	•	•	•	•	•	•	•	•	•	•
	Voice synthesizer		•	•	•	•	•	•	•	•	•	•	•	•	•	•	•	•
CAR OPERATING PANEL MATERIAL	ST01 St St Base		•	•	•	•	•	•	•	•	•	•	•	•	•	•	•	•
	ST02 St St Plus		•	•	•	•	•	•	•	•	•	•	•	•	•	•	•	•
CAR PUSH BUTTONS	Door close push button		•	•	•	•	•	•	•	•	•	•	•	•	•	•	•	•
	Braille push button		•	•	•	•	•	•	•	•	•	•	•	•	•	•	•	•
	Key switch push button (Standard or eurocylinder)		•	•	•	•	•	•	•	•	•	•	•	•	•	•	•	•
	External call cancelling		•	•	•	•	•	•	•	•	•	•	•	•	•	•	•	•
	Coded call		•	•	•	•	•	•	•	•	•	•	•	•	•	•	•	•
LANDING INDICATOR	7 Segment		•	•	•	•	•	•	•	•	•	•	•	•	•	•	•	•
	Dot-matrix		•	•	•	•	•	•	•	•	•	•	•	•	•	•	•	•
	Next lift indicator		•	•	•	•	•	•	•	•	•	•	•	•	•	•	•	•
	Landing gong		•	•	•	•	•	•	•	•	•	•	•	•	•	•	•	•
LANDING PUSH BUTTONS	Key switch push button (Standard or eurocylinder)		•	•	•	•	•	•	•	•	•	•	•	•	•	•	•	•
	Wall mounted push buttons		•	•	•	•	•	•	•	•	•	•	•	•	•	•	•	•

### MIRRORS

MIRRORS	MT (Mirror 3/4 narrow)		•F	•F	•F	•F	•F	•F	•F	•F	•F	•F	•F	•F			•F	
	MW (Mirror 3/4 wide)																•F	•F
FINISH	Rear-view mirror (EN 81-70)		•	•	•	•	•	•	•	•	•	•	•	•	•	•	•	•
	O1 Clear		•	•	•	•	•	•	•	•	•	•	•	•	•	•	•	•

### HANDRAILS

	HR04 (Stainless steel pipe)		•L	•L	•L	•L	•L	•L	•F/L	•F/L	•F/L	•F/L	•F/L	•F/L	•L	•F/L	•L
--	-----------------------------	--	----	----	----	----	----	----	------	------	------	------	------	------	----	------	----

### FINISHES

SKIRTINGS	SK01 Anodized Aluminium (St St finish)		•	•	•	•	•	•	•	•	•	•	•	•	•	•	•	•
DOOR MATERIAL (car and landing)	ST01 St St Base		•	•	•	•	•	•	•	•	•	•	•	•	•	•	•	•
	ST02 St St Plus		•	•	•	•	•	•	•	•	•	•	•	•	•	•	•	•
	Primed sheet (landing door)		•	•	•	•	•	•	•	•	•	•	•	•	•	•	•	•
DOOR PANEL TYPE	Standard panel (not big vision)		•	•	•	•	•	•	•	•	•	•	•	•	•	•	•	•

### FLOORS

SC-PVC HIGH	SC01 Red Cherry																	
	SC03 Grey Ice							•		•								
	SC04 Grey Storm		•	•				•		•								
	SC05 Grey Silver				•	•												
	SC06 Beige Sand																•	
OTHERS	Prepared for granite		•	•	•	•	•	•	•	•	•	•	•	•	•	•	•	•
	Prepared for PVC		•	•	•	•	•	•	•	•	•	•	•	•	•	•	•	•